



Huskie TOOLS®

SLA-758U

SLA-RL758U MILWAUKEE BATTERY POWER | SLA-MK758U MAKITA BATTERY POWER

6 TON BATTERY OPERATED INLINE COMPRESSION TOOL

OPERATOR MANUAL



LINEMAN PROVEN

UTILITY APPROVED

SINCE 1976

WARNING To reduce the risk of injury, user must read and understand manual completely before first using this product and save this manual for future use

Huskie Tools is not affiliated with, authorized, or endorsed by Milwaukee Electric Tool Corporation. Milwaukee listed batteries and chargers are being re-sold by Huskie Tools. Milwaukee® M18™ REDLITHIUM™ are registered trademarks of Milwaukee Electric Tool Corporation. Huskie Tools is not affiliated with, authorized, or endorsed by Makita® Corporation. Makita® listed batteries and chargers are being re-sold by Huskie Tools. Makita® and LXT® are registered trademarks of Makita® Corporation.



**Huskie
TOOLS®**

**BUILT FOR EVERYTHING
THAT'S ON THE LINE.™**

HUSKIETOOLS.COM

PRE-USE CHECKLIST:

- Visually confirm there are no missing or broken components. If found, stop use and have the tool checked by a qualified technician.
- Check and ensure triggers are moving freely with no binding.
- Rotate head where applicable to ensure it rotates 180 degrees. If head rotates more than 180 degrees, stop use and have tool checked by a qualified technician.
- Please read the instructions supplied with the battery and charger. Make sure to use supplied batteries or batteries that do not exceed 5.0Ah



**Thank you for purchasing
a Huskie Tools product.**

Our mission is to supply the finest cable connecting and cutting tools and cable-related products to the transmission and distribution markets. Huskie Tools products will represent state-of-the-art tools and be dependable and safe.

THE POWER TO CHOOSE.

TABLE OF CONTENTS

MODEL: SLA-758U

Description	4
Safety Symbols	5
Safety Information	6
Operating Instructions	7
Troubleshooting Guide	8
Warranty Information	9

SLA-758U

6 TON INLINE COMPRESSION TOOL—WITH LATCHED HEAD

The SLA-758U is a Streamline Battery-Powered Compression tool with a 6-ton output.

EACH TOOL KIT INCLUDES:

SLA-758U TOOL

18V - LI-ION BATTERY PACK (X2)

BATTERY CHARGER

TOOL BAG

COMPONENTS

INTEGRATED LED WORK LIGHT

SELECTABLE AUTO-RETRACT SWITCH

RELEASE TRIGGER

LATCHED CRIMP HEAD

SLA-RL758U



18V - LI-ION BATTERY

ADVANCE TRIGGER

SPECIFICATIONS

SPECIFICATIONS	
CRIMP FORCE	6 Ton
WEIGHT	6.90 lbs
DIMENSIONS (H X L X W)	17.5" x 3.75" x 2.75"

CONNECTOR RANGE	
LUGS & SPLICES	#8 to 500 MCM Cu #8 to 350 MCM Al
H-TAPS	Up to 4/0-4/0

Note: Weight and Dimensions taken w/o battery

Huskie Tools is not affiliated with, authorized, or endorsed by Milwaukee Electric Tool Corporation. Milwaukee listed batteries and chargers are being re-sold by Huskie Tools. Milwaukee® M18™ REDLITHIUM™ are registered trademarks of Milwaukee Electric Tool Corporation. Huskie Tools is not affiliated with, authorized, or endorsed by Makita® Corporation. Makita® listed batteries and chargers are being re-sold by Huskie Tools. Makita® and LXT® are registered trademarks of Makita® Corporation.

SAFETY SYMBOLS

You will see this symbol  Exclamation-Triangle throughout this manual. This purpose of this symbol is to call your attention to hazards and/or unsafe practices that have the potential to cause injury or property damage. The severity of each hazard is further explained in detail below. Failure to follow all instructions may result in electric shock, fire and/or serious injury. The term “power tool” in all warnings refers to your battery operated (cordless) power tool.



 DANGER
Immediate hazards are present which will result in severe injury or death if not avoided.

 CAUTION
Hazards or unsafe practices may result in injury or property damage if not avoided.

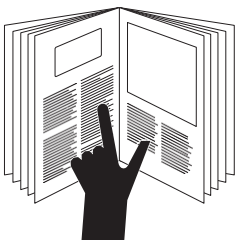
 CAUTION
Hazards or unsafe practices may result in injury or property damage if not avoided.

 WARNING	
	Read all instructions and safety information detailed in this operator manual prior to operating or servicing this tool. Failure to observe this warning could result in severe injury or death.

 CAUTION	
	Wear Eye Protection: Use safety glasses when operating or servicing this tool to prevent eye injury from flying debris.

 DANGER	
	Electric Shock Hazard: Use appropriate personal protective equipment when using this unit on or near energized electrical lines.

 DANGER	
	Pinch Point Hazard: Remove battery before servicing. Keep hands away from crimping head during cycle.

 DANGER	
	Cutting Hazard: Remove battery before servicing. Keep hands away from cutting head during cycle.



DO NOT DISCARD THIS PRODUCT OR THROW AWAY!

FOR RECYCLING INFORMATION, CONTACT 800-822-8837

SAFETY INFORMATION

DANGER

WORK AREA SAFETY

- Keep work area clean and well lit. Cluttered or dark areas invite accidents.
- Do not operate power tools in explosive atmospheres, such as in the presence of flammable liquids, gases or dust. Power tools create sparks which may ignite the dust or fumes.
- Keep bystanders away while operating a power tool. Distractions can cause you to lose control.

CAUTION

PERSONAL SAFETY

- Stay alert, watch what you are doing and use common sense when operating a power tool. Do not use a power tool while you are tired or under the influence of drugs, alcohol or medication. A moment of distraction while operating power tools may result in personal injury.
- Use personal protection equipment. Always wear eye protection. Safety equipment such as dust mask, non-skid safety shoes, hard hat, or hearing protection used for appropriate conditions will reduce personal injuries.
- Do not overreach. Keep proper footing and balance at all times. This enables better control of the power tool in unexpected situations.

WARNING

TOOL USE AND CARE

- To prevent leakage, overheating, smoke generation, fire, and rupturing from occurring, follow these instructions when handling our rechargeable power tools (tool main body/battery pack/charger).
- Do not force the tool. Use the correct tool for your application. The correct tool will do the job better and safer at the rate for which it was designed.
- Do not use the tool if the switch does not turn it on and off. Any tool that cannot be controlled with the switch is dangerous and must be repaired.
- Disconnect the battery pack from the tool before making any adjustments, changing accessories, or storing. Such preventive safety measures reduce the risk of starting the tool accidentally.
- Store idle tools out of the reach of children and do not allow persons unfamiliar with the tool or these instructions to operate the tool. These tools can be dangerous in the hands of untrained users.
- Maintain tools. Check for misalignment or binding of moving parts, breakage of parts and any other condition that may affect the tools operation. If damaged, have the tool repaired before use.
- Use power tools only with specifically designated battery packs. Use of any other battery packs may create a risk of injury and fire.
- Under abusive conditions, liquid may be ejected from battery; avoid contact. If contact accidentally occurs, flush with water. If liquid contacts eyes, additionally seek medical help. Liquid ejected from the battery may cause irritation or burns.

OPERATING INSTRUCTIONS

Compression

- 1) Select the appropriate size dies for the connector being used.
- 2) Open the head by pulling down on the grooved end of the latch and insert half of the die into the jaw by sliding it while pressing the die release pins on both sides of the jaw. Then insert the other half of the die into the die holder on the piston while pressing the die release pins on both sides of the holder.

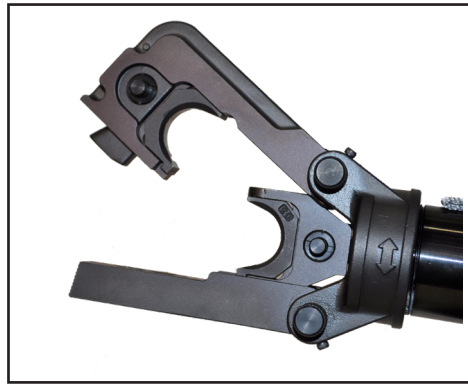
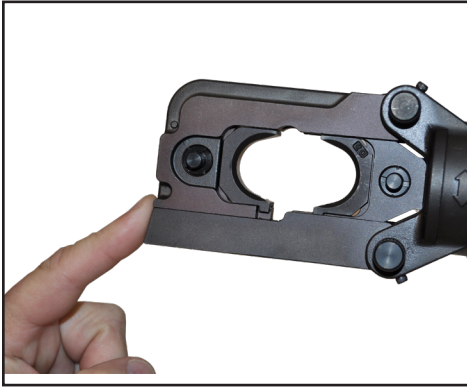

- 3) Press the trigger to activate the tool and advance the ram so the connector is held between the dies. Once the connector is securely held, place the conductor into the connector.
- 4) Press and hold the trigger until the compression is completed. (Figure 2) The ram will advance and once the cycle is complete, the tool will automatically shut off. If the cycle was not completed, the LED work lights will flash rapidly alerting the user the cycle was not completed.
- 5) The ram will automatically return once trigger is released when in Auto-Retract mode. If the switch is in manual mode, the release trigger will need to be depressed to retract the ram.
- 6) Open the latch and remove the conductor from the tool.

SELECTABLE AUTO RETRACT

The auto retract feature can be toggled on or off depending on user preference or specific job requirement. To turn auto retract on or off - toggle switch as shown below



TROUBLESHOOTING GUIDE

BEFORE YOU BEGIN

1. Make sure that the battery is charged and is a 5.0Ah or below. Recheck the battery after several minutes to make sure the battery is holding its charge.
2. Use a nonflammable contact cleaner or pencil eraser to clean the electrical contacts on the battery and tool.
3. Reinstall the battery and check the tool again.

SLC-RL7ND		
PROBLEM	CAUSE	SOLUTION
Motor runs but the tool jaws will not advance	Insufficient hydraulic oil	Consult factory for repair service
	Air block in hydraulic system	Invert tool to allow air to rise towards the top of the oil bladder
	Defective hydraulic circuit	Consult factory for repair service
Motor runs, tool jaws advance, but will not build pressure	Insufficient hydraulic oil	Consult factory for repair service
	Defective suction valve or bypass cartridge	Invert tool to allow air to rise towards the top of the oil bladder
Motor will not run at all	Defective battery	Charge or replace battery
	Bad contact or loose battery connections	Check all connections and wires
	Misaligned switch	Check to make sure that switch is properly aligned with trigger
Consult factory for repair service		
Tool jaws will not release	Tool did not complete a full cycle and bypass	Press trigger and allow tool to bypass, then release tool jaws
	Connector is jammed in tool jaws	Press and hold release trigger while prying tool jaws apart
	Release trigger is bent or misaligned	Consult factory for repair service

WARRANTY INFORMATION

SL/SLA-SERIES BATTERY OPERATED PRODUCTS	5 YEARS
REC-SERIES BATTERY OPERATED PRODUCTS	5 YEARS

BATTERIES	3 YEARS
------------------	----------------

CHARGERS	3 YEARS
-----------------	----------------

The warranty does not cover any damages incurred from a Huskie tool including damages to property, bodily injuries and lost wages resulting from such injuries. This warranty solely covers the repair or replacement of tools supplied by Huskie. These remedies are exclusive, and the total liability of Huskie Tools, LLC whether based on contract, warranty, negligence, indemnification, strict liability or otherwise, shall not exceed the purchase price of the tool. In no event, shall Huskie Tools, LLC be liable for consequential, incidental or special damages.

HUSKIE TOOLS, LLC MAKES NO OTHER WARRANTIES OF ANY KIND, EXPRESSED OR IMPLIED, AND ALL IMPLIED WARRANTIES INCLUDING ANY WARRANTY OF MERCHANTABILITY AND FITNESS FOR A PARTICULAR PURPOSE ARE DISCLAIMED.

Huskie reserves the right to determine all warranty claims. Huskie will not warranty tools containing parts or batteries not originally supplied by Huskie. Failure due to misuse, improper maintenance, misapplication, not following instructions or warnings, abuse or repairs attempted by anyone other than Huskie Tools, LLC, or an authorized service center renders this warranty null and void.

REPAIR AND WARRANTY CLAIMS

All claims must be sent to Huskie for inspection and authorization. A Return Goods Authorization (RGA) is required before shipping tools to Huskie. Secure the authorization by telephoning or writing to Huskie's main office with details of the claim. Non-warranty repairs are handled using the same procedure. Repairs exceeding 50 percent of the cost of a new tool will be advised before repairs are made.

MAINTENANCE NOTES

MAINTENANCE NOTES



**Huskie
TOOLS®**

2105 Corporate Dr. Unit B

Addison, IL 60601

PHONE 800-860-6170

FAX 800-345-3767

HUSKIETOOLS.COM